

Ezekiel  
B-12-148  
McKlehenny's Land.

William Lackey's Survey

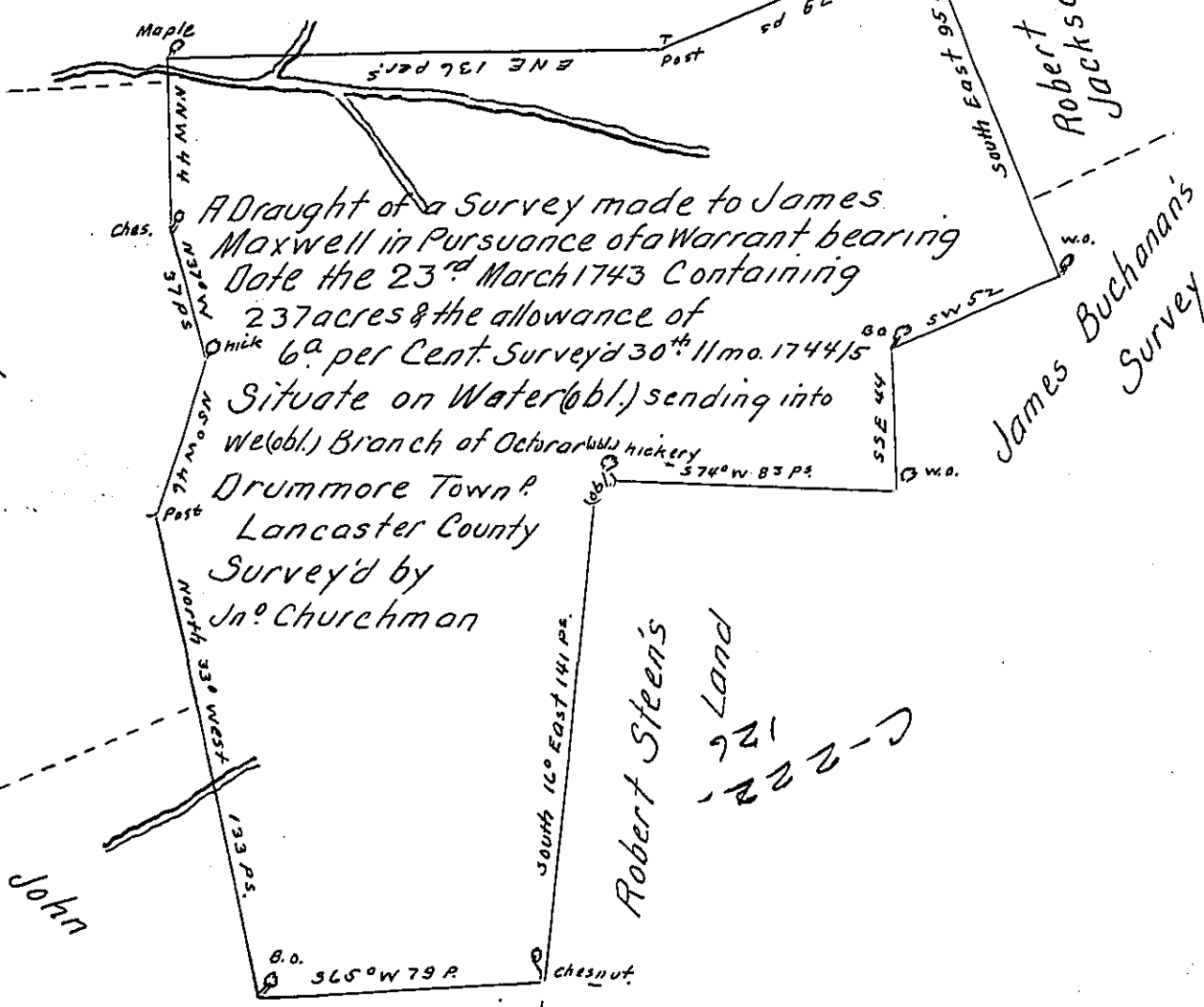

A Draught of a Survey made to James Maxwell in Pursuance of Warrant bearing Date the 23<sup>rd</sup> March 1743 Containing 237 acres & the allowance of 6<sup>th</sup> per Cent. Survey'd 30<sup>th</sup> 11 mo. 1744/5 Situate on Water (obl.) sending into We (obl.) Branch of Octara (obl.) Hickory Drummore Town? Lancaster County Survey'd by Jn. Churchman

162  
-E2A-D

126  
-C-222-D

John

Robert Steen's Land

Grey's Land  
19-69-C

(obl.) above Survey Begins at a Corner Black oak of Robert Jackson's Survey & Runs thence by Land of Ezekiel McKlehenny NE 79<sup>ps</sup> &c &c. Laid down by a Scale of 60 p. to an Inch

p. George Churchman —

IN TESTIMONY that the above is a copy of the original remaining on file in the Department of Internal Affairs of Pennsylvania, made conformably to an Act of Assembly approved the 16th day of February, 1833, I have hereunto set my Hand and caused the Seal of said Department to be affixed at Harrisburg, this twenty first day of December 1905.

*Francis P. Brown*  
Secretary of Internal Affairs.